

Bug Bites® "C" Spring Rider - Lucky

IMPORTANT! Prior to installation of any components, refer to **Playsystem Installation Guidelines and Tips** in the *Install 101* section of your manual. This section will provide important tips pertaining to **site preparation, footings, system stabilization**, and other necessary information **vital to the success of your installation.**



960

Lucky "C" Spring Rider

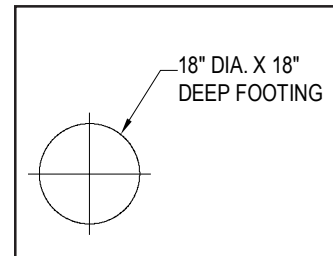

TOOLS AND EQUIPMENT REQUIRED

Also see 'Suggested Tools & Equipment' (Doc. # D70052) in 'Installations 101'

1. Concrete for footings, wheelbarrow or mixer, 5 gallon bucket, water supply
2. Digging equipment for footings (spade shovel, post hole digger, auger)
3. 2 x 8's or other wood, nails, hammer to construct frame for concrete footing assembly
4. Tape measure and level
5. Allen and 6-lobe wrenches or bits, socket set, screwdrivers
6. For installation in concrete slabs: concrete saw
7. Adult installers - 2 minimum

Bug Bites® "C" Spring Rider - Lucky

STEP 1 DIG FOOTINGS

Consult the *CPSC Handbook* for guidelines for placement of Spring Riders, Bouncers, etc. Locate and dig **one 18" diameter footing, 18" deep**.

STEP 2 LEVEL BASE WELDMENT IN FOOTING

Level and plumb weldment within the footing.

Pour concrete within 6" of base top and allow concrete to cure completely prior to affixing Rider Assembly.

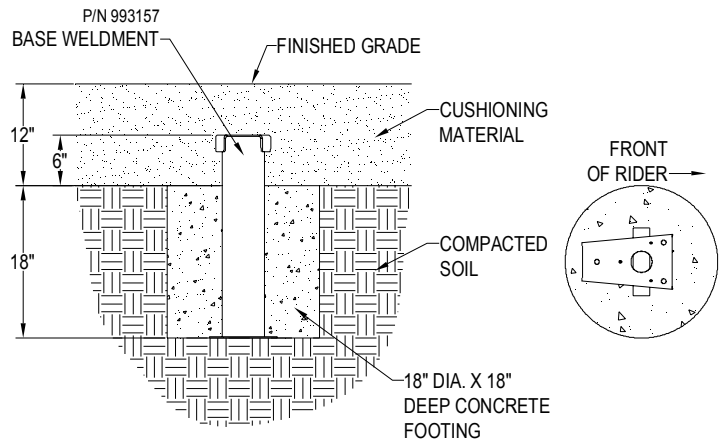

STEP 3 ATTACH "C" SPRING TO RIDER BODY

Bolt Pinch Plate over "C" Spring and Base as shown. Bolt Spring to front of Base. Ensure Spring is level and plumb on Base.

Bolting downward through Spring Rider Base (which is attached to Spring Rider Body), affix Spring Rider to "C" Spring.

NOTE: Spring Rider is attached to base. Do NOT detach to assemble "C" Spring.

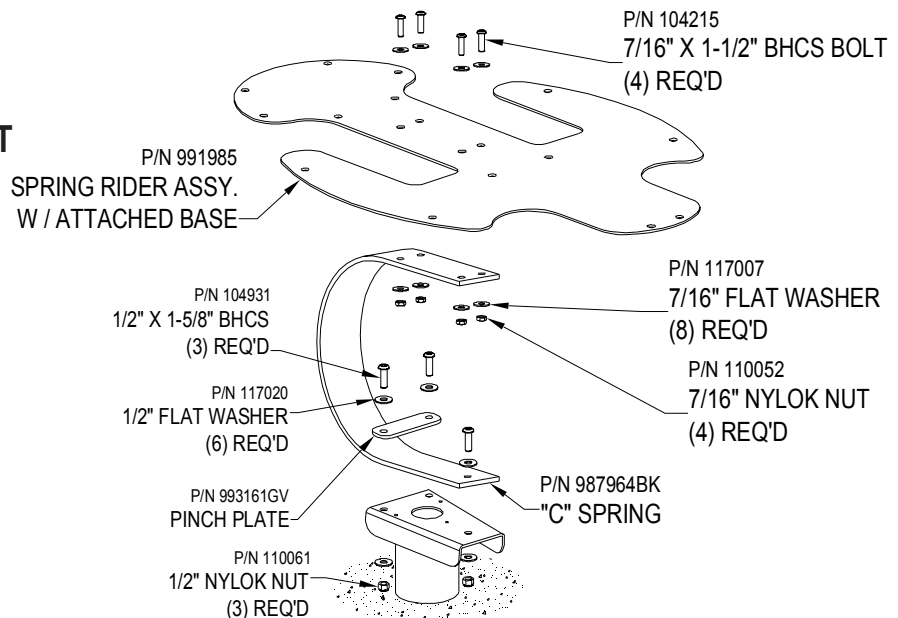

Bug Bites® "C" Spring Rider - Lucky

STEP 4 AFFIX IDENTIFICATION/WARNING STICKERS TO "C" SPRING

Apply provided Miracle identification and warning stickers to "C" Spring as shown.

IMPORTANT NOTE: It is imperative that these stickers are CLEARLY visible.

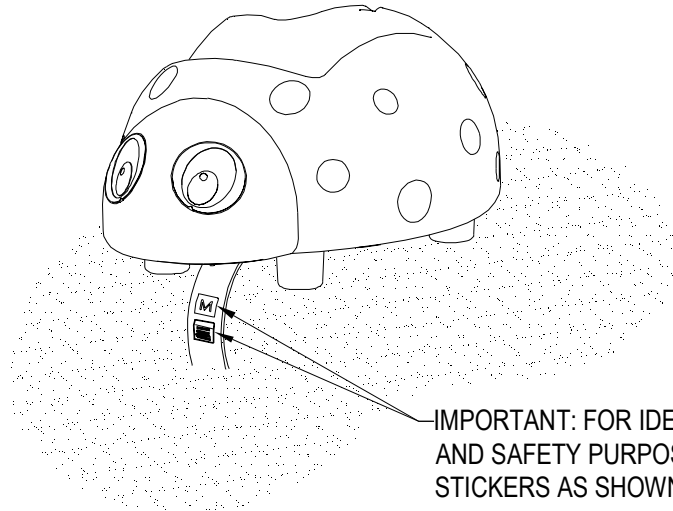

FINAL STEP

Refer to *Final Assembly installation* located behind *Installations 101* in Installation Manual.

Bill of Materials

LUCKY "C" SPRING RIDER - MODEL # 960

1	987964BK	"C" SPRING PAINTED BLACK
1	991985	LADYBUG SPRING RIDER ASSEMBLY
1	993157GV	BASE WELDMENT-C SPRING RIDER
1	993491	PARTS CARTON (SEE BELOW FOR CONTENTS)

PARTS CARTON # 993491

4	104215	BOLT 7/16-14 X 1-1/2 BHCS 6 LOBE 18-8 SS
3	104931	BOLT 1/2-13 X 1 5/8 BHCS 6 LOBE 18-8 SS
3	110061	NUT 1/2-13 HEX NYLOK 18-8 SS
8	117007	WASHER 7/16 FLAT 18-8 SS
6	117020	WASHER 1/2 FLAT 18-8 SS MS-819
1	993161GV	PINCH PLATE-C SPRING RIDERS GALVANIZED
4	110052	NUT 7/16-14 HEX NYLOK 18-8 SS
2	116021	LABEL MIRACLE ID - GENERIC
2	116022	LABEL WARNING - PLAYGROUND
1	104478	BIT T-50 TORX FOR 7/16 6-LOBE BHD BOLT
1	104481	BIT T-55 FOR 1/2 BOLT